



Surface box in SMC

Use

- Surface box and manhole in composite material, resistant to a temperature of 200°C.
- Allows the passage of a key for the operation of a valve buried on a water network.

Description

- Provides protection and accessibility to the maneuvering square of the connexion ball valves, shut-off valve, etc.
- Lockable by a rotating key system, it protects networks against theft and vandalism.
- Possibility to write an identification on the manhole (text, shape, logo)

Application

Sidewalk and roadway.

Technical characteristics

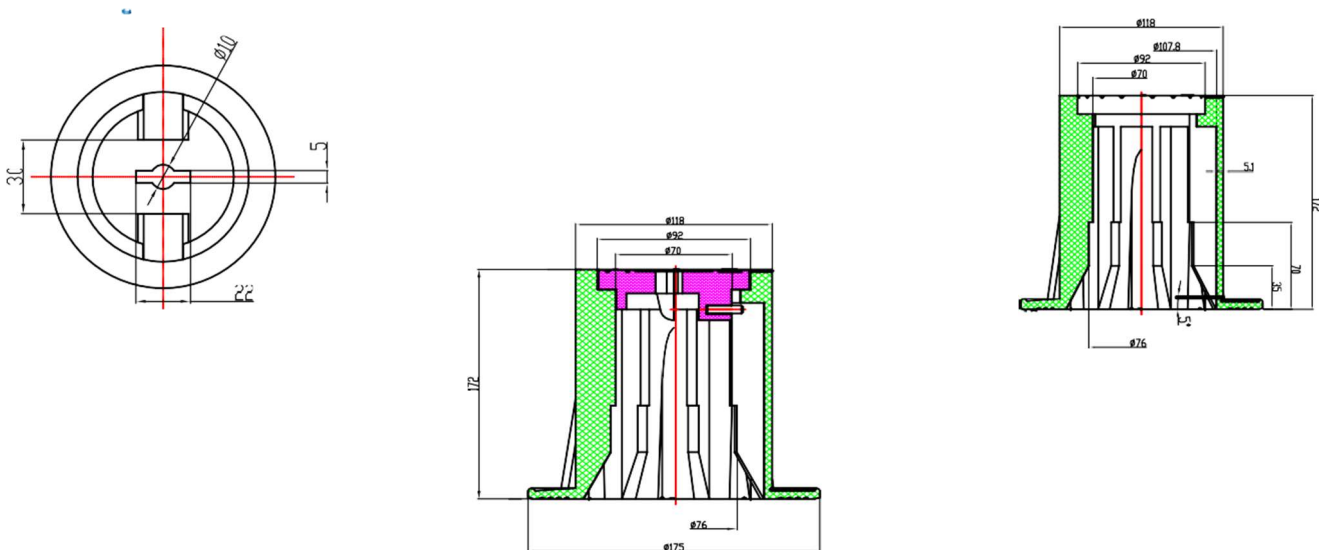

Normative compliance

- Standards: EN 124 test method

ALMA - MANUFACTURE MAROCAINE D'EQUIPEMENTS PUBLICS - MMEP - S.A.

Z.I. Had Soualem, Douar LAASILAT, Commune de Sahel, Ouled Hriz-Cercle de Berrechid-26400 MAROC.

Tél.: +212 5 22 99 51 52 - Fax : +212 5 22 99 49 50

Email : contact@alma.ma – Website : www.alma.ma

